

# **track set-up & accessories**

LINE.S5

LINE.S10

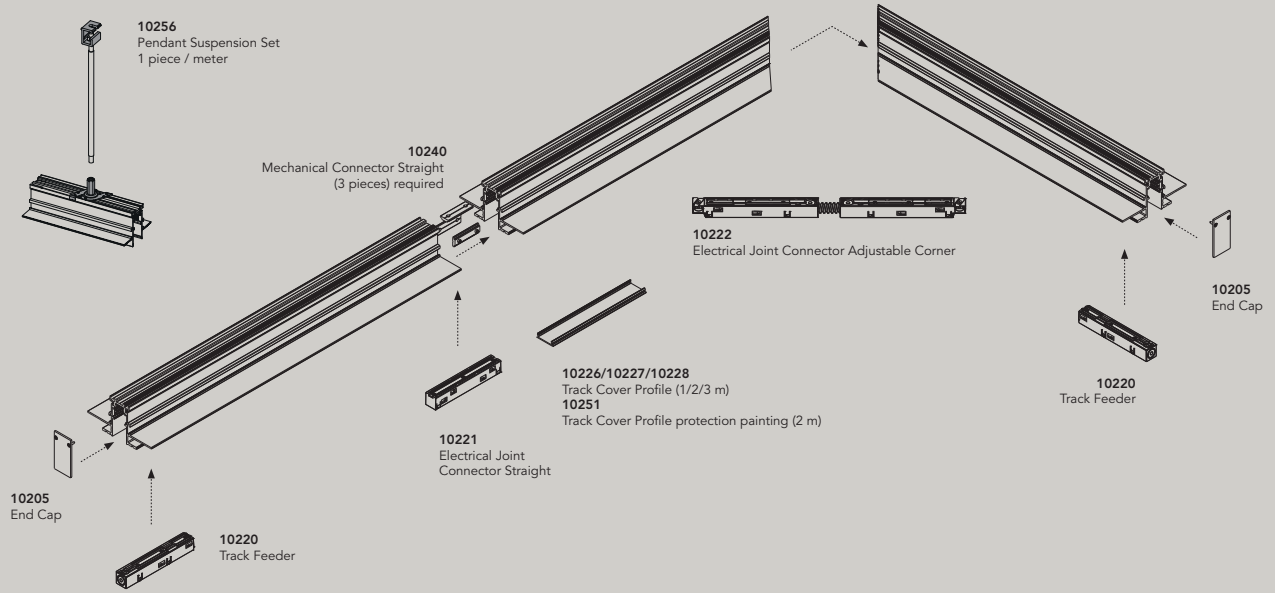
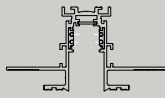
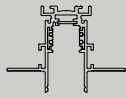

LINE.S2

LINE.S6

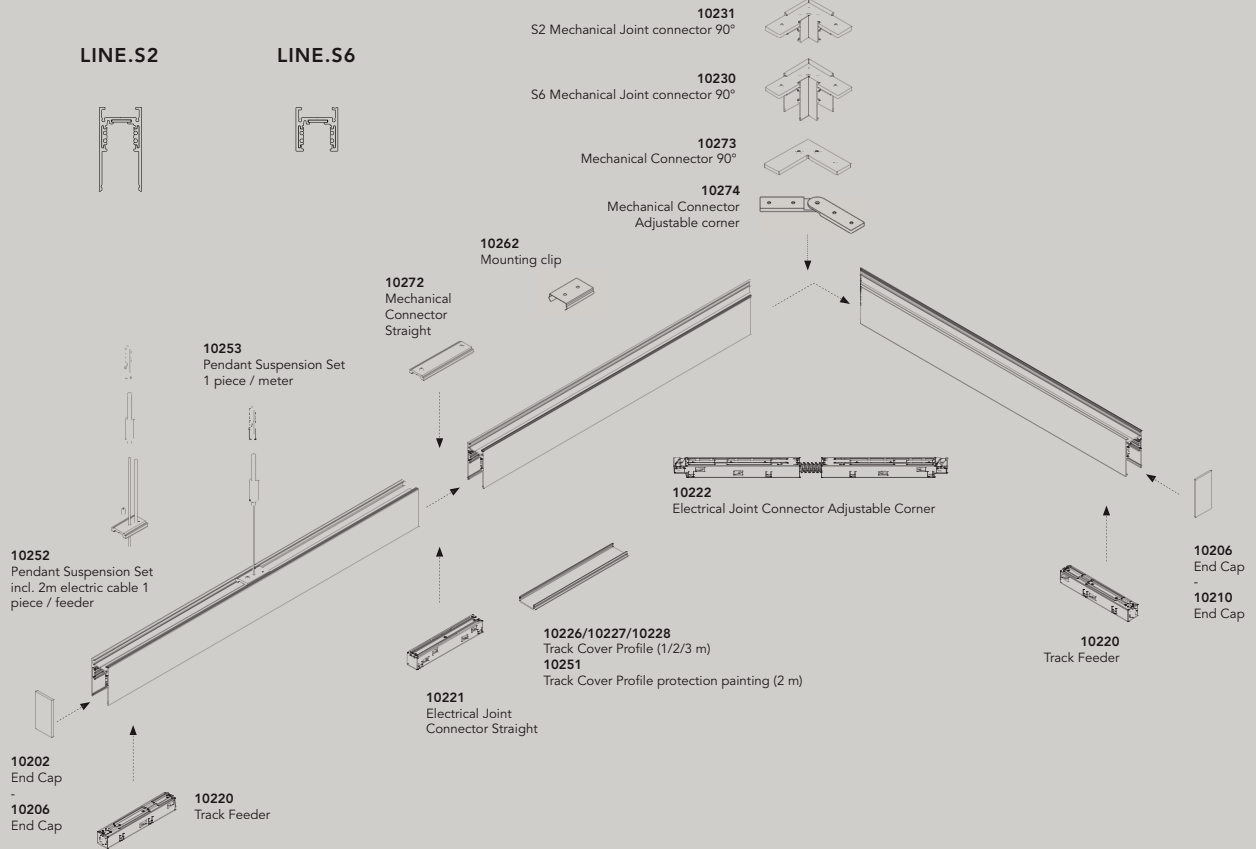

## LINE.S8

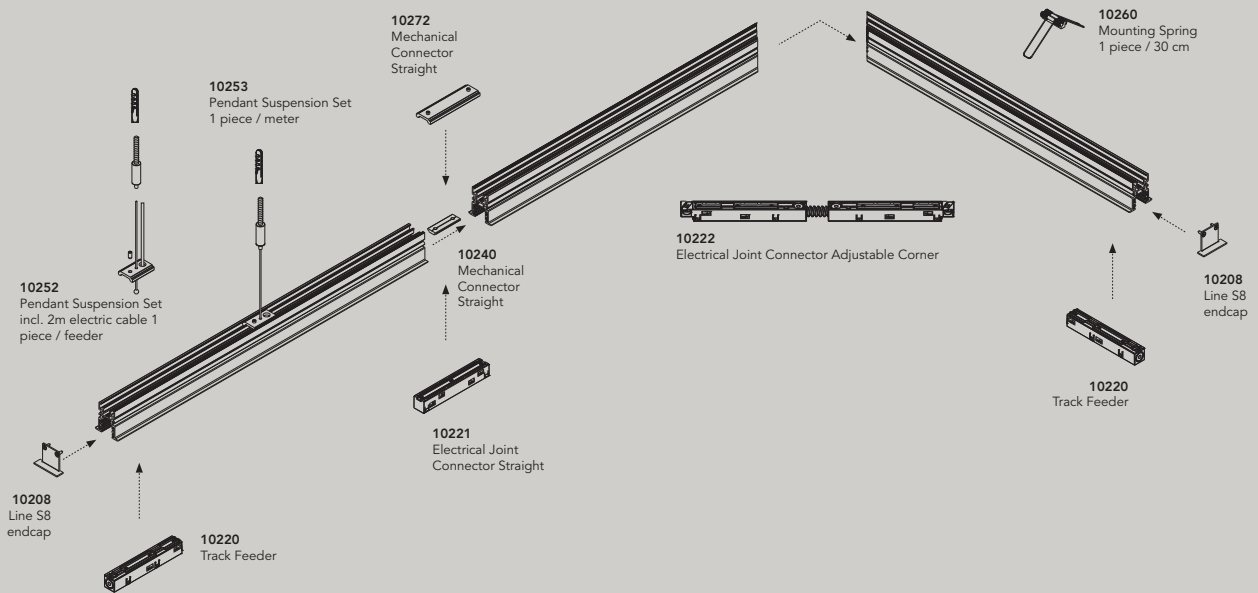

## LINE.S3

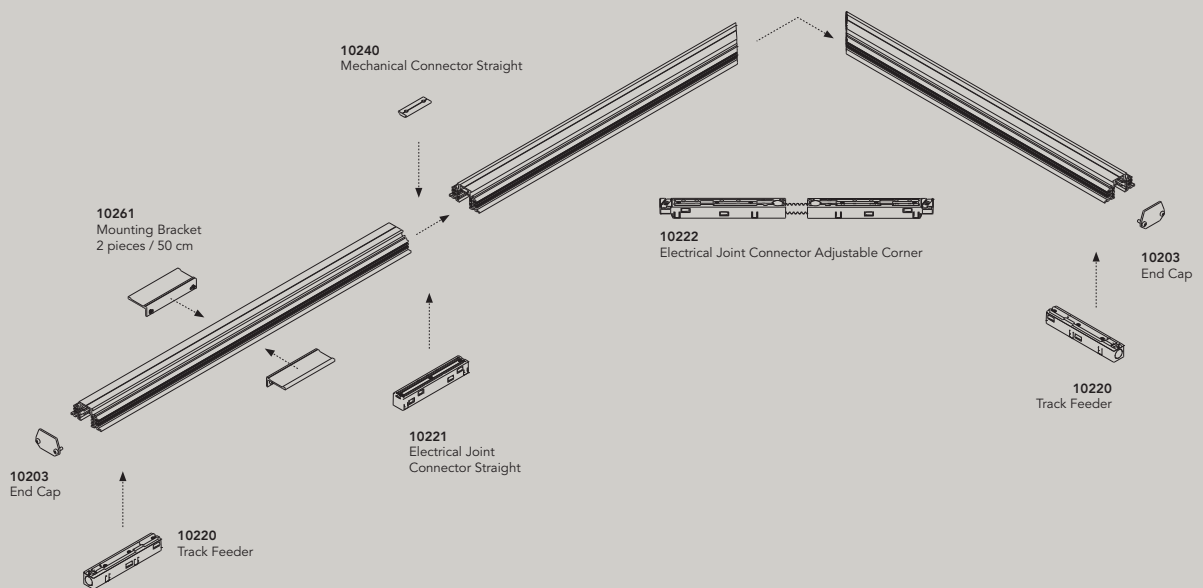

## LINE.S9

77

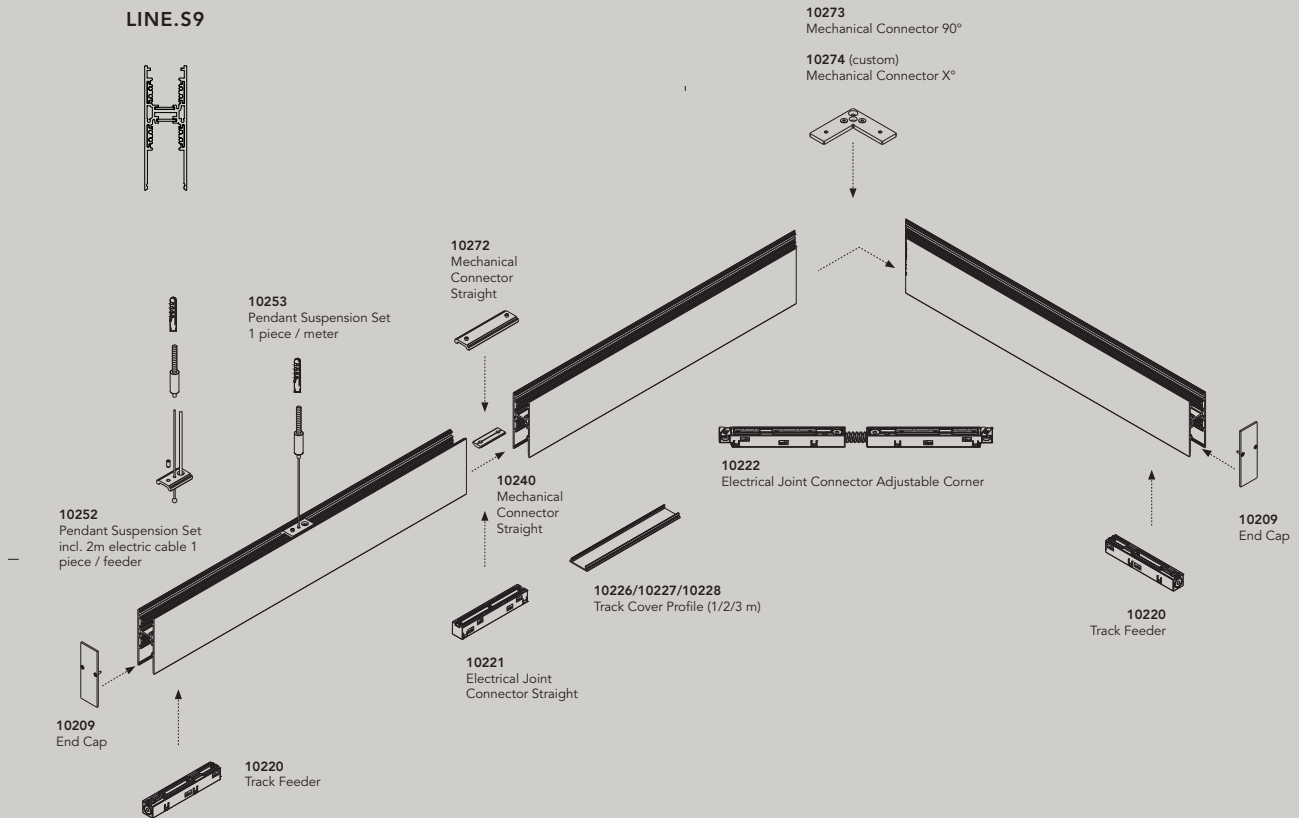

# 48V Power supplies & controls

## Order Code



90101.0000  
90102.0000  
90103.0000  
90104.0000

Power supply, 48VDC, 60W - 90-305 VAC/50-60Hz - CE - cUL certified  
Power supply, 48VDC, 100W - 90-305 VAC/50-60Hz - CE - cUL certified  
Power supply, 48VDC, 150W - 90-305 VAC/50-60Hz - CE - cUL certified  
Power supply, 48VDC, 240W - 90-305 VAC/50-60Hz - CE - cUL certified

90110.0000

Power supply, 48VDC, 60W - 120-240VAC/50-60Hz - CE - cUL listed  
(Slim size - fits in track Line S2, S5 & S10)

90111.0000

Power supply, 48VDC, 100W - 120-240VAC/50-60Hz - CE - cUL listed

90001.0000

0/1-10V to dali interface (up to 15 fixtures) 24vdc. \*dali expander for more fixtures

90002.0000

Switch dim to dali interface (up to 64 fixtures) and DALI expander 200mA 100-240vac

90003.0000

Dali opto insulator for galvanic isolation

90010.0000

casambi to dali interface for remote installation 48Vdc (up to 4 groups, max 50 fixtures)

90011.0100

casambi to dali interface for track Line S installation 48Vdc (1 group, max 50 fixtures) black

90011.0200

casambi to dali interface for track Line S installation 48Vdc (1 group, max 50 fixtures) white

90012.0000

casambi push button interface (up to 4 push buttons) 110-240vac

90013.0100

casambi wall remote control wireless (up to 4 groups) black

90013.0200

casambi wall remote control wireless (up to 4 groups) white